

Multimode Inline Tap Avalanche Power Monitor

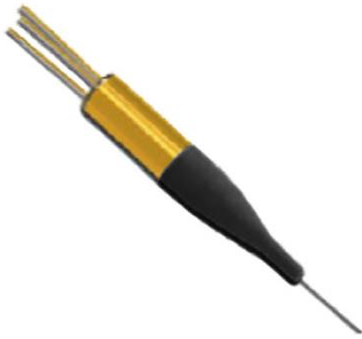

DATASHEET

BUY NOW



Features

- Easy for Integrating
- Low Loss Device
- Custom Tap Ratios Available
- Compact Design
- Low dark current
- Hermetically sealed

Applications

- DWDM Channel Monitoring
- Power Monitoring in Optical Interface Modules
- Gain Monitoring for Amplifier
- EDFAs and Raman amplifiers
- Compact Design

The Tap Optical Power Monitor is a hybrid fiber optical passive component that integrates a thin-film tap of flat spectral response with a Silicon photodiode for power monitoring applications near 850nm. The Silicon detector provides a low noise measurement while conventional InGaAs detectors are less sensitive at 850nm wavelength band. The Power Monitor minimizes component assembly costs and module footprint while increasing module design efficiency by facilitating fiber Management. This tap monitor is designed for low speed power monitor, not for high speed data processing.

The Power Monitor combines the functionality of an optical coupler and a photodiode while delivering low insertion loss and low dark current with high temperature stability over a wide wavelength range.

Specifications

Parameter	Min	Typical	Max	Unit
Operating Wavelength Range		770 ~ 860		nm
Insertion Loss ^[1] (5% Tap)			0.8	dB
Return Loss ^[1]	30			dB
PD Responsivity ($\lambda=800\text{nm}$, $oe=1\mu\text{W}$, $M=100$)	35	50		mA/W
Dark Current ($T=23^\circ\text{C}$, $M=100$)	0.02	0.05	0.4	nA
Operating Temperature Range	0		70	$^\circ\text{C}$
Storage Temperature Range	-40		85	$^\circ\text{C}$
Fiber Type	Multi-mode 50 μm or 62.5 μm core			

Notes:

[1]. Excluding connectors

Note: The specifications provided are for general applications with a cost-effective approach. If you need to narrow or expand the tolerance, coverage, limit, or qualifications, please [\[click this link\]](#):

Warning: The device is extremely ESD-sensitive. Its dark current increases by unprotected handling. It is recommended to be handled under a certified ion fan once the package is removed.

Legal notices: All product information is believed to be accurate and is subject to change without notice. Information contained herein shall legally bind Agiltron only if it is specifically incorporated into the terms and conditions of a sales agreement. Some specific combinations of options may not be available. The user assumes all risks and liability whatsoever in connection with the use of a product or its application.

Rev 08/05/24

Multimode Inline Tap Avalanche Power Monitor



DATASHEET

Mechanical Footprint Dimensions (mm)

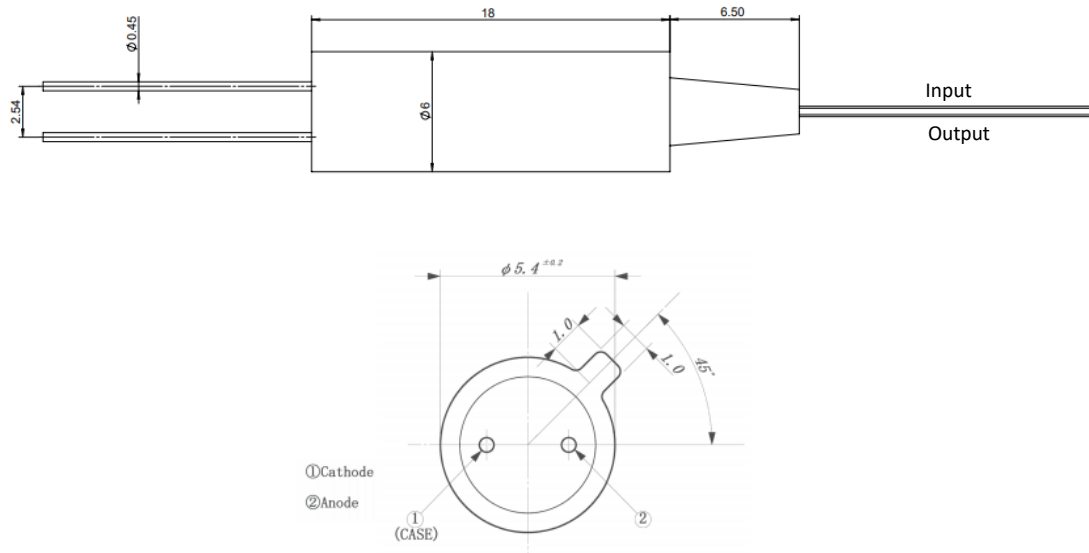

*Product dimensions may change without notice. This is sometimes required for non-standard specifications.

Ordering Information

Prefix	Tap Ratio	Wavelength	Bandwidth	Fiber Type	Fiber Cover	Fiber Length	Connector
M	2-5% * = 01 10% = 10 Special = 00	850nm = 8 1550nm = 5 Special = 0	0.1G = 01	50/125um = 2 62.5/125um = 3 Special = 9	Bare fiber = 1 Loose tube = 2 Special = 3	0.25m = 1 0.5m = 2 1.0m = 3 Special = 0	None = 1 FC/PC = 2 FC/APC = 3 SC/PC = 4 SC/APC = 5 ST/PC = 6 LC/PC = 7 Duplex LC/PC = 8 MTP = 9 LC/APC = A LC/UPC = U Special = 0

* Multimode tap ratio is related to the laser mode field. We use CPR-14 to test

Multimode Inline Tap Avalanche Power Monitor



DATASHEET

Spectral Response

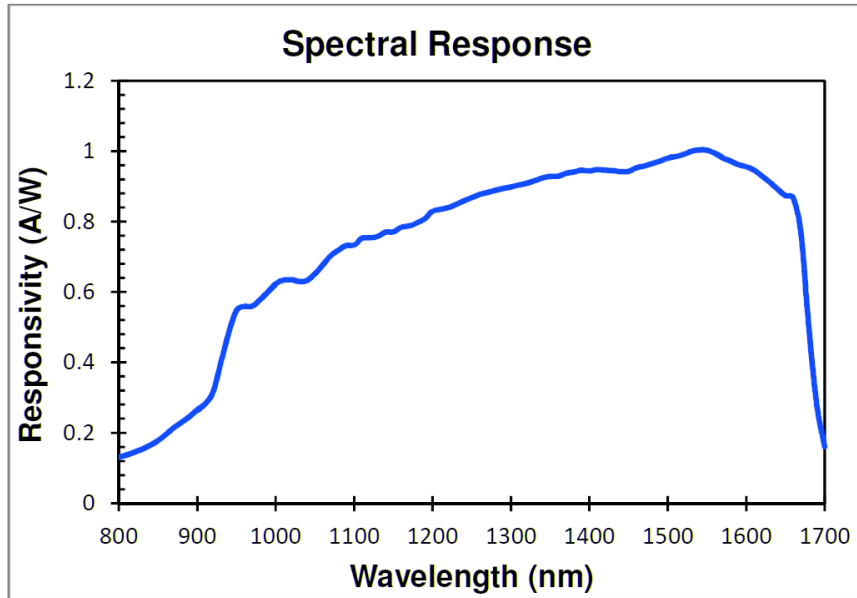

Application Notes

Fiber Core Alignment

Note that the minimum attenuation for these devices depends on excellent core-to-core alignment when the connectors are mated. This is crucial for shorter wavelengths with smaller fiber core diameters that can increase the loss of many decibels above the specification if they are not perfectly aligned. Different vendors' connectors may not mate well with each other, especially for angled APC.

Fiber Cleanliness

Fibers with smaller core diameters (<5 μm) must be kept extremely clean, contamination at fiber-fiber interfaces, combined with the high optical power density, can lead to significant optical damage. This type of damage usually requires re-polishing or replacement of the connector.

Maximum Optical Input Power

Due to their small fiber core diameters for short wavelength and high photon energies, the damage thresholds for device is substantially reduced than the common 1550nm fiber. To avoid damage to the exposed fiber end faces and internal components, the optical input power should never exceed 20 mW for wavelengths shorter 650nm. We produce a special version to increase the how handling by expanding the core side at the fiber ends.